

Ashleigh  
Lower Swell  
Cheltenham  
Gloucestershire  
GL54 1LF/

To all members of Shrivenham Parish Council.  
I hope it is alright if I address this letter to the Parish clerk Mrs Julia Evens.

Dear Mrs Evens,

My name is John Stock together with my partner Beatrice Walsh we are buying a house in Shrivenham, 17b the Beeches Highworth rd. Our proposed moving in date is 26<sup>th</sup> June

When we received the land registry title plan from the estate agents we noticed straight away the plan and the actual boundary were not correct. We were missing part of the bottom of the garden and some of the side.

The boundary has a wild hedge road side and a wooden fence at the rear. The wild hedge should be parallel with the path, but it tapers in and the existing partial fence has been erected well inside the boundary. The bottom fence should be shared with the neighbours but our side fence has been erected incorrectly cutting off the entire corner, to which we are entitled, the lost corner is overgrown with weeds and brambles we need to reclaim that wasted ground.

We intend to manage the hedge and erect a wooden close board fence which will re-establish the title plan. We must begin work as soon as we move as the hedge may look solid but has many gaps making it insecure for animals both getting in and out of our garden.

We hope this meets with your approval as it will improve the appearance from the road side. The picture shows how bad it looks and how untidy and unkempt the wild hedge is.

Would you be so kind to answer our letter as soon as possible either by post phone or email (john.stock46@yahoo.co.uk) it would be much appreciated.

Yours sincerely,

Beatrice Walsh and John Stock



# HM Land Registry

## Current title plan

Title number **ON303839**  
Ordnance Survey map reference **SU2389SE**  
Scale **1:1250 enlarged from 1:2500**  
Administrative area **Oxfordshire : Vale of White Horse**

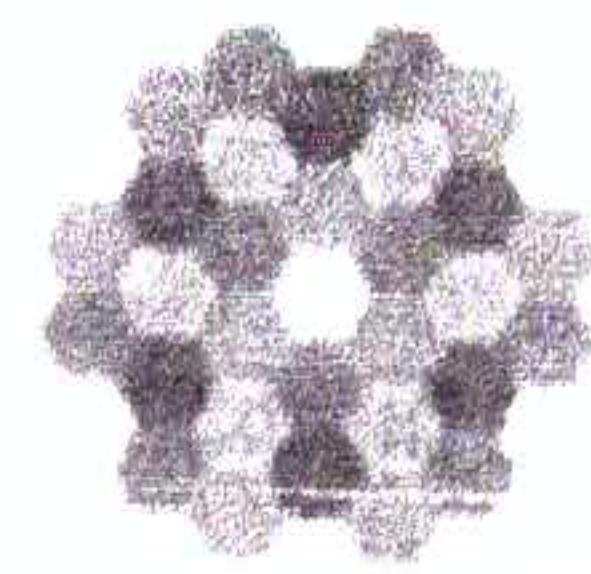

This is a copy of the title plan on 28 FEB 2020 at 16:37:09. This copy does not take account of any application made after that time even if still pending in HM Land Registry when this copy was issued.

This copy is not an 'Official Copy' of the title plan. An official copy of the title plan is admissible in evidence in a court to the same extent as the original. A person is entitled to be indemnified by the registrar if he or she suffers loss by reason of a mistake in an official copy. If you want to obtain an official copy, the HM Land Registry web site explains how to do this.

- HM Land Registry endeavours to maintain high quality and scale accuracy of title plan images. The quality and accuracy of any print will depend on your printer, your computer and its print settings. This title plan shows the general position, not the exact line, of the boundaries. It may be subject to distortions in scale. Measurements scaled from this plan may not match measurements between the same points on the ground.

This title is dealt with by HM Land Registry, Gloucester Office.



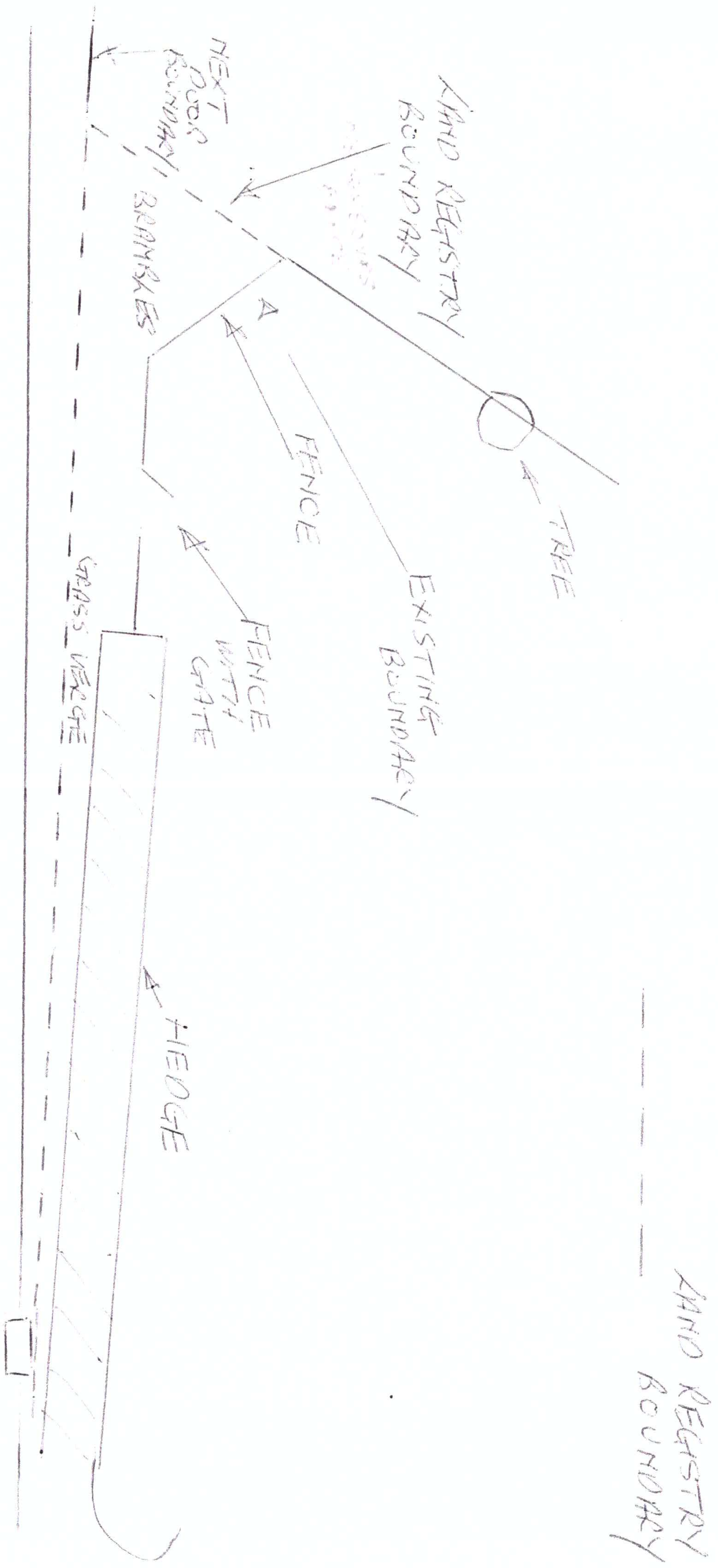









2



